

THE CITY OF NAPOLEON

BUILDING & ZONING DEPARTMENT

255 W. RIVERVIEW

(419)592-4010

Building Permit

Page 1 of 1

Permit Number: BP2005-134

Printed: 8/23/2005

Property Address: 1106 Riverview Ave. W

Applicant J & M Construction
Address: 17792 Kinner Rd

Approval Date: 8/23/2005

New Bavaria, OH 43548

Phone: 419-980-0462

Owners

Name: Mr. Tim Holt
Address: 1106 W Riverview Ave.

Phone: 419-

Contractors J & M Construction
Address: 17792 Kinner Rd
New Bavaria, OH 43548

Phone 419-980-0462

Fees and Receipts:

Number	Description	Amount
FEE2005-652	Building Permit Fee (Auto)	\$29.00
Total Fees:		\$29.00

Description

Structure Use:

Start Date:

Construction Value: \$15,000.00

End Date:

Floor Areas

Living Space:

Other:

Basement/Storage:

Total Area:

Garage:



Description of work to be done: Front deck

Applicant signature: _____ **Date:** _____

CITY OF NAPOLEON GENERAL PERMIT APPLICATION

THIS APPLICATION IS FOR RESIDENTIAL CONSTRUCTION INCLUDING BUILDING, ELECTRICAL, PLUMBING, MECHANICAL, DEMOLITIONS, REMODELING.

DATE: 8/22 JOB LOCATION: 1106 Riverview

OWNER: Tim Holt PHONE: 419-

OWNER ADDRESS: _____ CITY: _____ ZIP: _____

CONTRACTOR: J+M construction PHONE: 419-980-0462

CONTRACTOR LICENSED WITH THE CITY OF NAPOLEON?: YES: _____ NO: _____

Is any of this job going to be subcontracted out? Yes: _____ No:

If yes to whom: _____

DESCRIPTION OF WORK TO BE PERFORMED: Replace windows, siding, build deck

PLEASE MARK THE TYPE OF WORK YOU WILL BE PERFORMING

- | | |
|---|--|
| <input type="checkbox"/> A/C ADD ON | <input type="checkbox"/> REMODELING |
| <input type="checkbox"/> BOILER REPLACEMENT | <input type="checkbox"/> ROOFING |
| <input type="checkbox"/> CURBING | <input type="checkbox"/> SEWER REPAIRS** |
| <input checked="" type="checkbox"/> DECKS * | <input type="checkbox"/> SIDEWALK* |
| <input type="checkbox"/> DRIVEWAY* | <input checked="" type="checkbox"/> SIDING |
| <input type="checkbox"/> ELECTRICAL SERVICE UPGRADE | <input type="checkbox"/> STORAGE SHED* |
| <input type="checkbox"/> ELECTRICAL SERVICE NEW | <input type="checkbox"/> SWIMMING POOL* |
| <input type="checkbox"/> FENCE* | <input type="checkbox"/> FURNACE REPLACEMENT |
| <input type="checkbox"/> ADDITIONS* | <input type="checkbox"/> TEMP ELECTRIC |
| <input type="checkbox"/> FURNACE NEW | <input type="checkbox"/> WATER TAP (size _____") |
| <input type="checkbox"/> LAWN METER | <input checked="" type="checkbox"/> WINDOWS |
| <input type="checkbox"/> PLUMBING | <input type="checkbox"/> ZONING |

*PLEASE INCLUDE A PICTURE SHOWING MEASUREMENTS FROM EXISTING STRUCTURES AND PROPERTY LINES. INDICATING THE TYPE OF WORK YOU WISH TO PERFORM.

** IF WORK REQUIRES GOING INTO THE STREET A STREET BOND IS REQUIRED!

FOR PERMIT COSTS PLEASE FILL OUT REVERSE SIDE.

*** * * Take this sheet to the Building Materials desk to purchase your materials. * * ***

You have selected a 16' x 20' deck 3' off the ground.

Pressure Treated Framing Material

4 x 4 Framing Posts

Vertical Decking

5/4" x 6" Pressure Treated Deck Boards

36" White Premium Colonial PVC Railing

Plastic White Lattice

Poured Footings 8" Tube 4' deep

Premium Gold Combo Drive Screws

Stainless Steel Framing Fasteners

2" x 8" Joists

2" x 10" Beams

40 PSF Deck Live Load

Below is a section of the railing style and options you have selected for your deck.

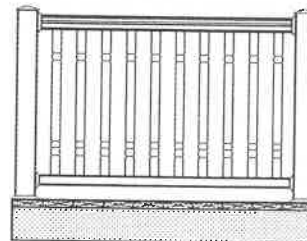

You may buy all the materials or any part at low cash and carry prices. Because of the wide variable in codes, Menards cannot guarantee that materials listed will meet your code requirements. Check with your local municipality for plan compliance and building permit. These plans are suggested designs and material lists only. Some items may vary from those pictured. We do not guarantee the completeness of prices of these structures. Tax, labor and delivery not included.

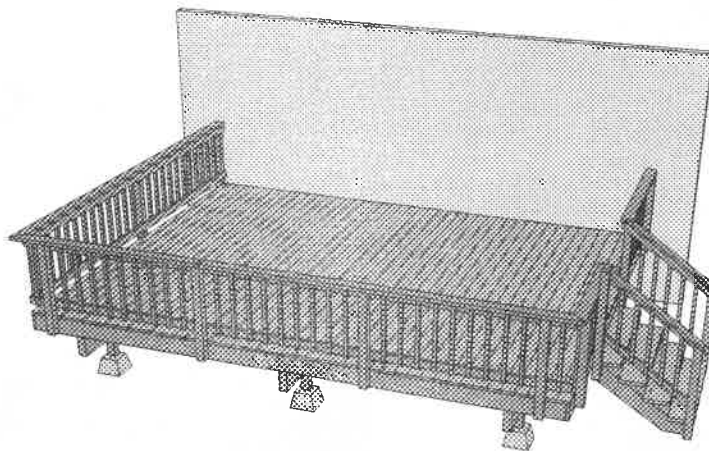

Illustration intended to show general deck size and shape.

Some options selected may not be shown for picture clarity.

Stair Widths : 60"

For Building Material's use only : 1922400360202530099000504048050100020301

Today's cost for materials estimated in this design with options: \$3009.83

***Base price may include: 40 PSF deck live load, horizontal decking, 2x6 pressure treated deck boards, pressure treated framing material, no stairs, 36" 2x4 railing, pressure treated railing posts, and premium green treated screws. *(BASE price): \$1711.35**



Please bring these plans to the cashier to purchase.

Post and Beam Dimension Sheet Design#:40231

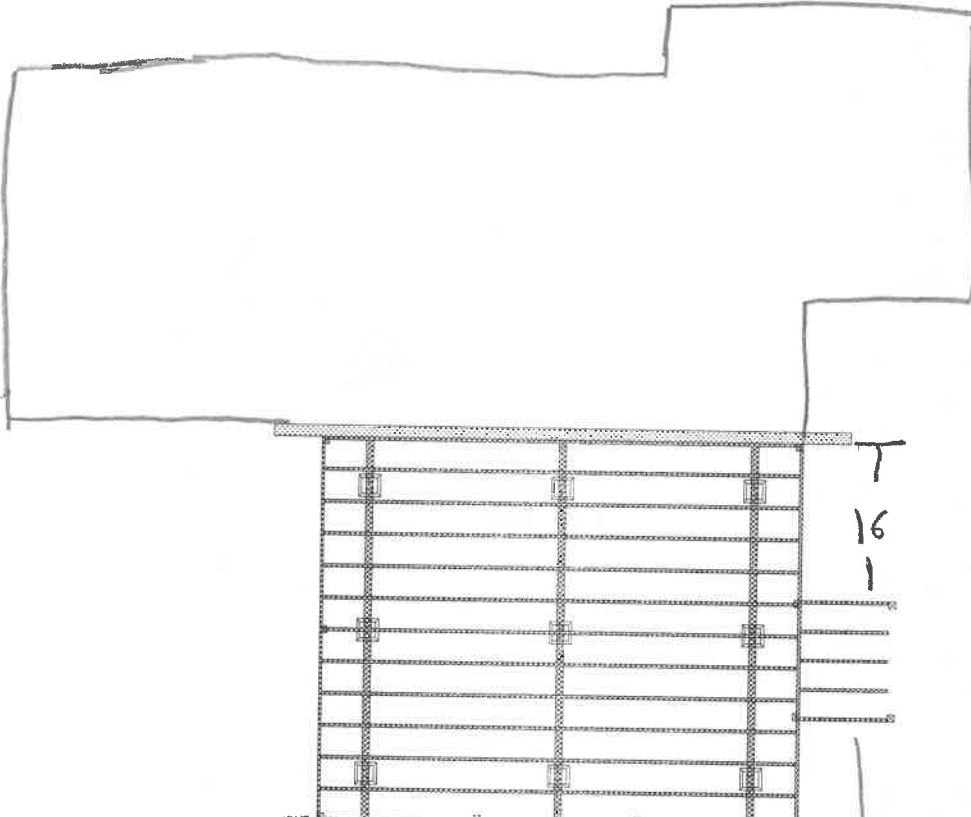
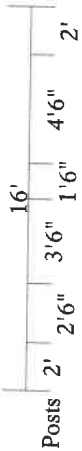

67ft.
- property pin 30ft. off center of Road

Drive

You may buy all the materials or any part at low cash and carry prices. Because of the wide variable in codes, Menards cannot guarantee that materials listed will meet your code requirements. Check with your local municipality for plan compliance and building permit. These plans are suggested designs and material lists only. Some items may vary from those pictured. We do not guarantee the completeness or prices of these structures. Tax, labor and delivery not included.

⊠ - Denotes railing posts.

Layout dimension sheets are intended as a construction aid. Not all options selected are shown.

Joist Layout for Your Deck

The Scale is 1/4" : 1'

Design#: 40231

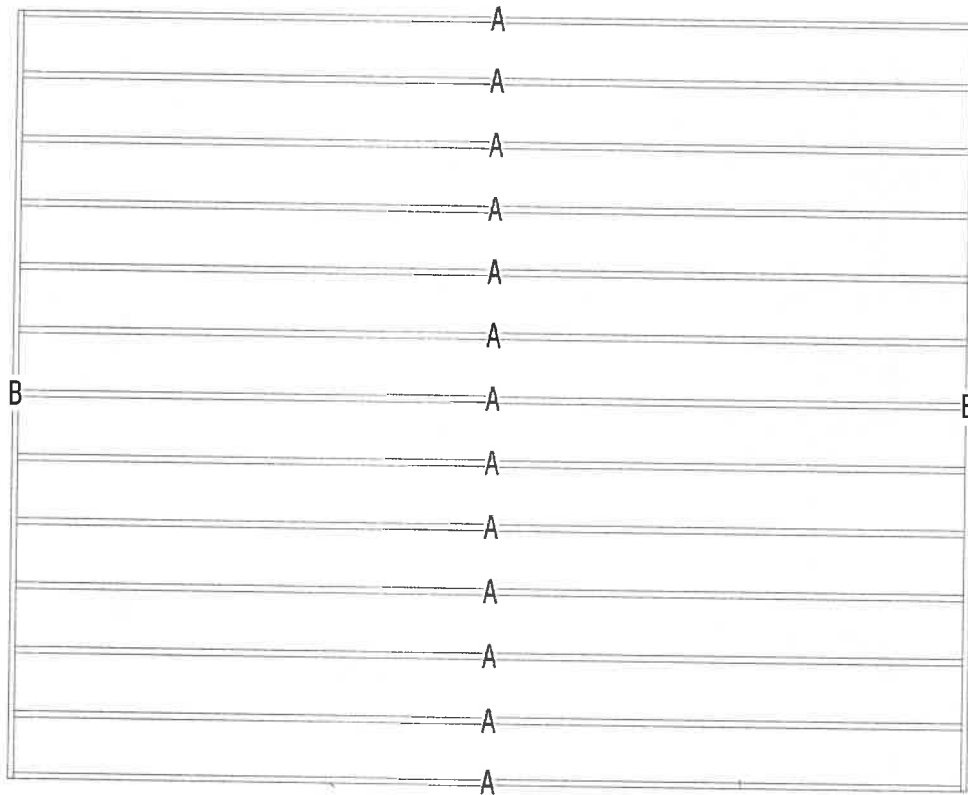

Mark	Length	Description	Usage
A	19'9"	2x8 Green Treated	Joist
A	19'9"	2x8 Green Treated	Rim joist
B	16'	2x8 Green Treated	Rim joist

Joists to be on 16" centers.

Joists to be hung from the ledger with joist hangers.

Joists to be toe-nailed to beams with 3-1/2" (16d) galvanized nails.

Rim joists to be face-nailed to joists & ledgers with 3-1/2" (16d) galvanized nails.

Blocking and bridging are not shown, but may be required by your local code.

You may buy all the materials or any part at low cash and carry prices. Because of the wide variable in codes, Menards cannot guarantee that materials listed will meet your code requirements. Check with your local municipality for plan compliance and building permit. These plans are suggested designs and material lists only. Some items may vary from those pictured. We do not guarantee the completeness or prices of these structures. Tax, labor and delivery not included.

Beam Layout for Your Deck

The Scale is 1/4" : 1'

Design#: 40231

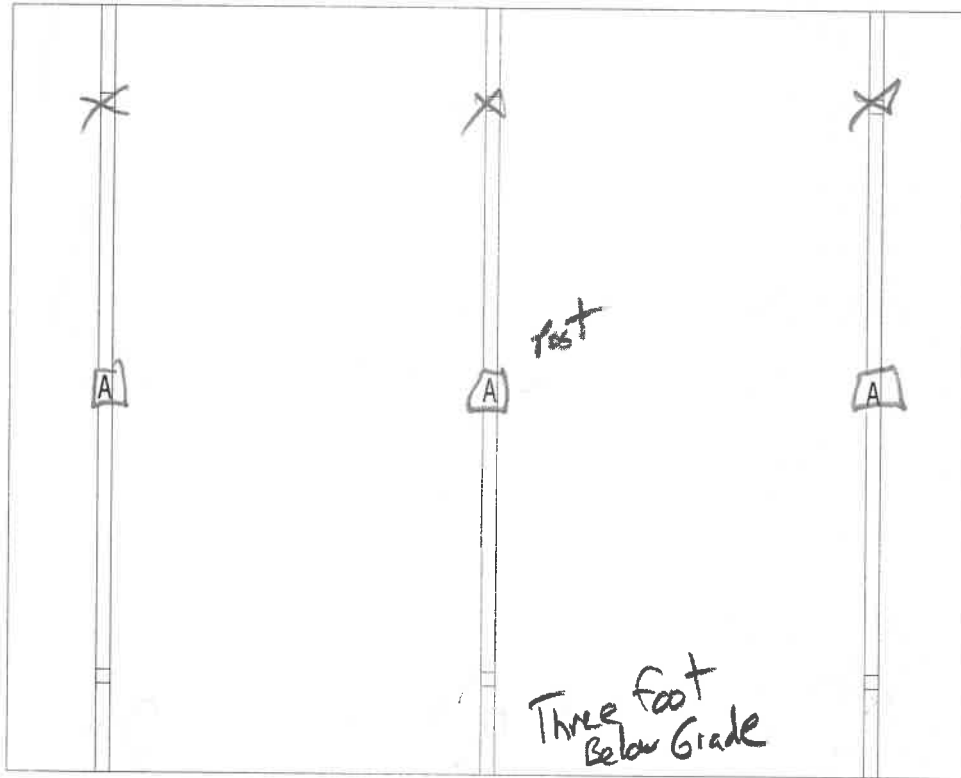

Mark	Length	Description
A	16'	2-2x10 Green Treated

You may buy all the materials or any part at low cash and carry prices. Because of the wide variable in codes, Menards cannot guarantee that materials listed will meet your code requirements. Check with your local municipality for plan compliance and building permit. These plans are suggested designs and material lists only. Some items may vary from those pictured. We do not guarantee the completeness or prices of these structures. Tax, labor and delivery not included.

Layout dimension sheets are intended as a construction aid. Not all options selected are shown.